

# — THE FIR

TOWNHOMES



1575 SQ.FT. 3 BED 2.5 BATH

INCLUDING 245 SQ.FT. FINISHED BASEMENT

[claridgehomes.com](https://claridgehomes.com)



# THE FIR

TOWNHOMES

1575 SQ.FT. 3 BED 2.5 BATH

INCLUDING 245 SQ.FT. FINISHED BASEMENT

OPTIONAL UPGRADE

FINISHED BASEMENT 262 SQ.FT.

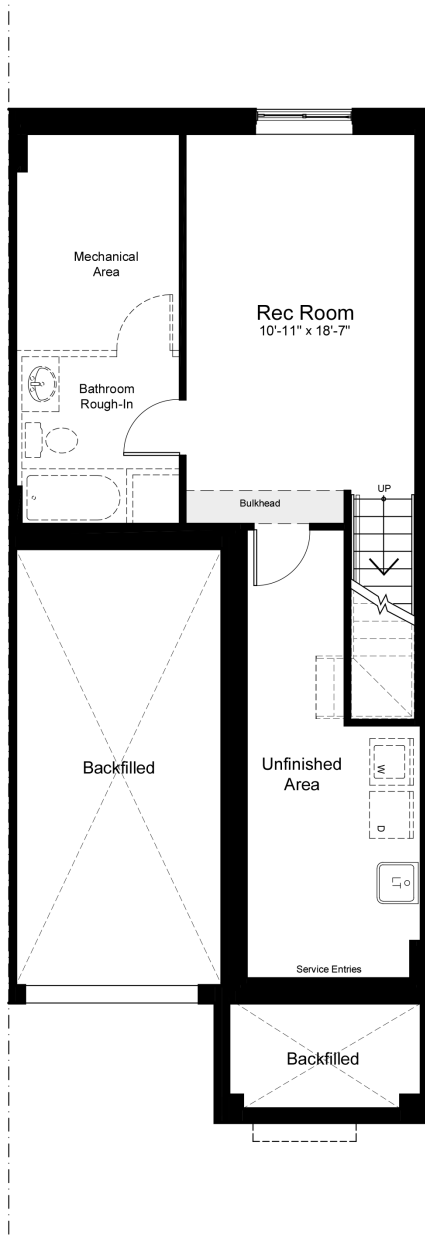

basement

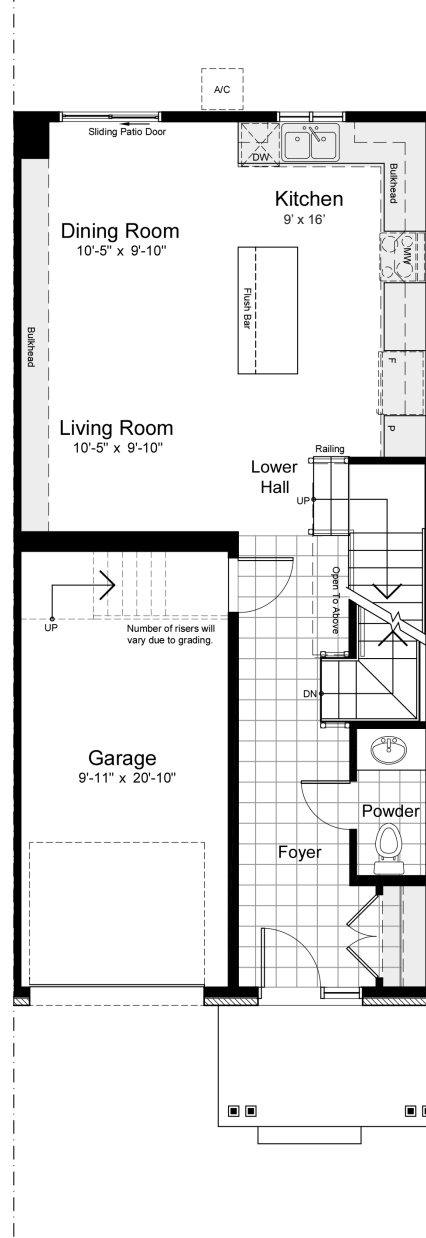

ground



second

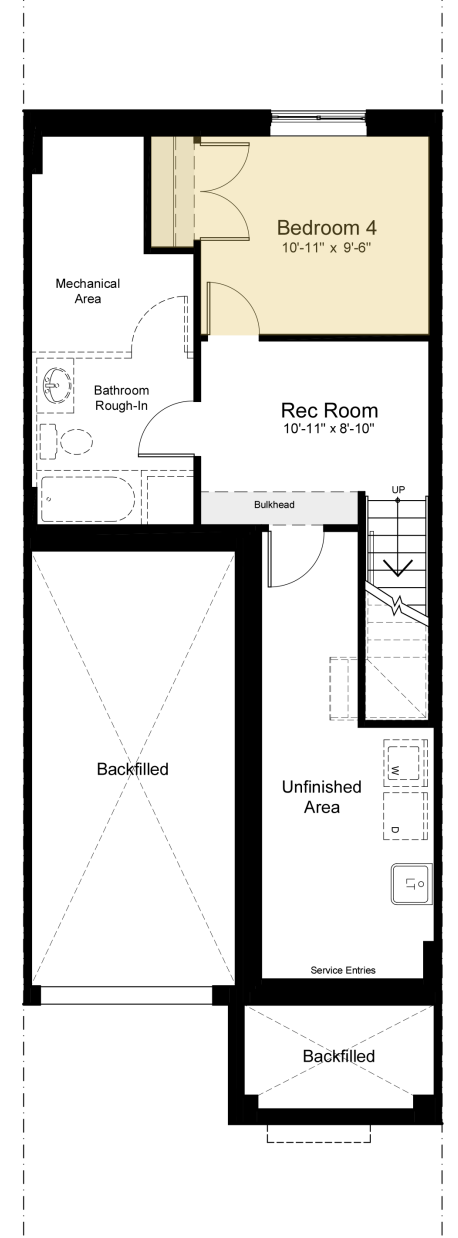

FINISHED REC ROOM  
+ BASEMENT BEDROOM